

# Infection Prevention



## Infection Prevention

### Cleaning Brushes

- HedgeHog™ Valve Brush .....81
- HedgeHog Double Bundle.....81
- HedgeHog Double-End Channel Brush .....81
- HedgeHog Dual-End Channel / Valve Brush .....81
- HedgeHog Sweeper Channel Brush .....81
- HedgeHog Single-End Channel Brush.....81

### Detergent

- Pure™ Enzymatic Detergent - Spearmint Fresh Scent.....81
- Pure Enzymatic Detergent - Fragrance Free.....81

### Bite Blocks

- Blox™ Endoscopic Bite Block with Elastic Cloth Strap (54 FR)....81
- Blox Endoscopic Bite Block with Elastic Cloth Strap (54 FR)  
(w/o Dental Retention).....81
- Blox Endoscopic Bite Block with Elastic Cloth Strap (60 FR).....81

### Lubricant

- Endoglide™+ Sterile Bacteriostatic Lubricating Gel.....82
- Sterile Lubricating Jelly .....82

### Gowns

- EndoArmor™ Gown .....82
- EndoArmor+ Gown .....82

### Irrigation & Insufflation

- Hydra™ Disposable Auxiliary Water Jet Connector.....82
- Hydra Water Bottle Cap.....82
- Hydra Irrigation Tubing.....82

### Scope Transport

- CinchPad™ Endoscope Transport Pad.....83

### Sponges

- Koala™ Cleaning Sponge .....83
- Koala Cleaning Sponge plus Pure Enzymatic .....83

### Suction Tubing

- Suction Tubing .....83

### Valves

- Orca™ Sterile Single-Use Air / Water & Suction Valves.....84
- OrcaPod™ 3 and 4 .....84
- Seal™ Single-Use Biopsy Valve .....84

### Compliance EndoKit™

- Compliance EndoKit.....84

# Infection Prevention

## Cleaning Brushes

HedgeHog™ Cleaning Brushes						
Order Number	GTIN	Description	Catheter/Handle Length (cm)	Brush Length (mm)	Brush Width (mm)	Packaging
SBB-119-50	00816849010274	HedgeHog Valve Brush	6	40, 35	10, 5	Box 50
SBB-382-50	00816849016900	HedgeHog Double Bundle	240, 6	13, 40 / 35	5, 10 / 5	Box 50
SBD-228-50	00816849010083	HedgeHog Double-End Channel Brush	240	13	5	Box 50
SBD-289-50	00816849010090	HedgeHog Dual-End Channel / Valve Brush	45mm, 240	40, 13	10, 5	Box 50
SBD-291-50	00816849016443	HedgeHog Sweeper Channel Brush	240	13, 120	13, 5.5	Box 50
SBS-227-50	00816849010076	HedgeHog Single-End Channel Brush	240	13	5	Box 50

## Detergent

Pure™ Enzymatic Detergents			
Order Number	GTIN	Description	Packaging
SEE-220-4	10840253105308	Pure Enzymatic Detergent - Spearmint Fresh Scent	Box 4
SEE-573-4	10840253105292	Pure Enzymatic Detergent - Fragrance Free	Box 4

## Bite Blocks

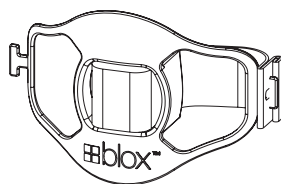

Blox™ Bite Blocks with Adjustable Straps			
Order Number	GTIN	Description	Packaging
SBT-114-100	00816849010168	Blox Endoscopic Bite Block with Elastic Cloth Strap (54 FR)	Box 100
SBT-321-100	00816849016764	Blox Endoscopic Bite Block with Elastic Cloth Strap (54 FR) (w/o Dental Retention)	Box 100
SBT-546-100	00840253104809	Blox Endoscopic Bite Block with Elastic Cloth Strap (60 FR)	Box 100

# Infection Prevention

## Lubricant



Endoglide™ + 			
Order Number	GTIN	Description	Packaging
SLT-394-100	00816849017167	Endoglide+ Sterile Bacteriostatic Lubricating Gel (32g / 1.1oz)	Box 100
SLT-395-50	00840253103055	Endoglide+ Sterile Bacteriostatic Lubricating Gel (56.7g / 2oz)	Box 50
SLT-612-50	20851809002900	Sterile Lubricating Jelly (56.7g / 2oz)	Box 50

## Gowns

EndoArmor™ Gown 			
Order Number	GTIN	Description	Packaging
SGE-368-100	00816849010281	EndoArmor Gown	Box 100
SGE-389-100	00816849016481	EndoArmor+ Gown	Box 100

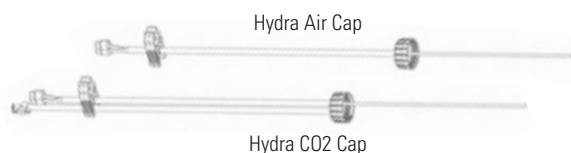
## Irrigation & Insufflation



Hydra™ Irrigation System								
Order Number	GTIN	Description	Scope Compatibility	CO2	Air/Water Tubing Length (in)	CO2 Tubing Length (in)	Packaging	
SIT-361-100	00816849016955	 Hydra Disposable Auxiliary Water Jet Connector	Olympus	N/A	N/A	N/A	Box 100	
SIT-470-100	00816849019895	 Hydra Disposable Auxiliary Water Jet Connector	Fuse	N/A	N/A	N/A	Box 100	
SCT-350-10	00816849016887	Hydra Water Bottle Cap System	Olympus	No	16	N/A	Box 10	
SCT-351-10	00816849016894	Hydra Water Bottle Cap System	Olympus	Yes	16	18	Box 10	
SCT-466-10	00816849019864	Hydra Water Bottle Cap System	Fuse	No	16	N/A	Box 10	
SCT-467-10	00816849019833	Hydra Water Bottle Cap System	Fuse	Yes	16	18	Box 10	
SIT-355-15	00840253112200	Hydra Irrigation Tubing System (compatible with ERBE, Medivators pumps)	N/A	N/A	N/A	N/A	Box 15	
SIT-576-15	00840253108401	Hydra Irrigation Tubing System (compatible with Olympus pumps)	N/A	N/A	N/A	N/A	Box 15	



# Infection Prevention

## Scope Transport

### CinchPad™ Endoscope Transport Pad



Order Number	GTIN	Description	Packaging
SPX-017-25	00816849010045	CinchPad Endoscope Transport Pad (990.6mm x 1054mm)	Box 25

## Sponges



Koala Sponge

### Koala™ Cleaning Sponges



Order Number	GTIN	Description	Packaging
SSB-210-50	00816849015613	Koala Cleaning Sponge	Box 50
SES-240-50	00816849015569	Koala Cleaning Sponge plus Pure Enzymatic	Box 50

## Suction Tubing

### Suction Tubing



Order Number	GTIN	Description	Packaging
SVT-089-100	00816849016788	Suction Tubing, NS, 3/16" x 6'	Box 100
SVT-090-100	00816849016795	Suction Tubing, NS, 3/16" x 10'	Box 100
SVT-095-100	00816849016801	Suction Tubing, NS, 3/16" x 12'	Box 100
SVT-143-100	00816849016818	Suction Tubing, NS, 1/4" X 6'	Box 100
SVT-144-60	00816849016825	Suction Tubing, NS 1/4" x 10'	Box 60
SVT-145-50	00816849016832	Suction Tubing, NS, 1/4" x 12'	Box 50



# Infection Prevention

## Valves



Orca™ Sterile Single-Use Air / Water & Suction Valves

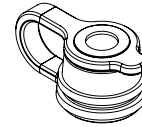

Seal™ Single-Use Biopsy Valve

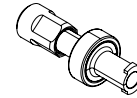

Hydra Disposable Auxiliary Water Jet Connector

### Orca™ Sterile Single-Use Air / Water & Suction Valves



Order Number	GTIN	Description	Scope Compatibility	Packaging
SUV-617-50	00840253111012	Orca Sterile Single-Use Air / Water & Suction Valves	Olympus	Box 50

### OrcaPod™



Order Number	GTIN	Description	Scope Compatibility	Packaging
SUV-628-50	08714729981565	OrcaPod 3 - Orca Sterile Single-Use Air/Water, Suction, and Seal Single-Use Biopsy Valve	Olympus	Box 50
SUV-629-50	08714729981589	OrcaPod 4 - Orca Sterile Single-Use Air/Water, Suction, and Seal Single-Use Biopsy Valve with WaterJet Connector	Olympus	Box 50

### Seal™ Single-Use Biopsy Valve



Order Number	GTIN	Description	Scope Compatibility	Packaging
SBC-501-50	08714729981602	Seal Single-Use Biopsy Valve	Olympus/Fuji	Box 50
SBC-501-100	08714729981602	Seal Single-Use Biopsy Valve	Olympus/Fuji	Box 100

## Compliance EndoKit™

### Compliance EndoKit



Order Number	GTIN	Description	Packaging
CEK-721-20	00840253113337	Compliance EndoKit Kit Components: CinchPad™ Endoscope Transport Pad, Gauze, EcoBowl, Koala™ Cleaning Sponge + Pure™ Enzymatic, Biohazard Label, HedgeHog™ DualEnd Channel/Valve Brush, Endoglide+ Sterile Bacteriostatic Lubricating Gel	Box 20

**Please consult your Boston Scientific Territory Manager on options to customize your Compliance EndoKit™ to meet your individual endoscope reprocessing needs.**

