

## Connecting Leads to Boston Scientific ICDs and CRT-Ds with White Seal Plugs

### SUMMARY

Boston Scientific has incorporated a new setscrew mechanism, an orange torque wrench, and white-colored silicone seal plugs for certain ICD and CRT-D families.

This article provides steps to ensure a successful lead connection for ICDs and CRT-Ds with white seal plugs.

ICD: Implantable Cardioverter Defibrillator  
 CRT-D: Cardiac Resynchronization Therapy Defibrillator

CRM PRODUCTS REFERENCED\*  
 CONFIENT™, LIVIAN™,  
 COGNIS™, and TELIGEN™

\*Products referenced herein may not be approved in all geographies. For comprehensive information on device operation, reference the appropriate product labeling.

### CRM CONTACT INFORMATION

Technical Services – U.S.  
 1.800.CARDIAC (227.3422)  
[Tech.Services@bsci.com](mailto:Tech.Services@bsci.com)

Technical Services – Europe  
 +32 2 416 7222  
[eurtechservice@bsci.com](mailto:eurtechservice@bsci.com)

LATITUDE Clinician Support  
 1.800.CARDIAC (227.3422)  
[latitude@bsci.com](mailto:latitude@bsci.com)

Patient Services  
 1.866.484.3268 – U.S. and Canada  
 001.651.582.4000 – International

### Steps to Ensure Lead Connection Success

**Step 1.** Look down the lead ports to visually verify that the setscrews are sufficiently retracted to allow insertion.

Verify that setscrews are not visible in lead ports.

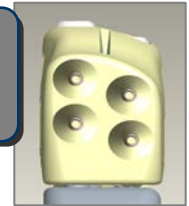

**Step 2.** Gently insert the torque wrench through the visible pre-slit center depression of the seal plug. This will open up the seal plug, providing a pathway to release fluid or air trapped within the lead port as the lead is inserted.

Inserting the torque wrench *before* the lead allows pressure to equalize during lead insertion.

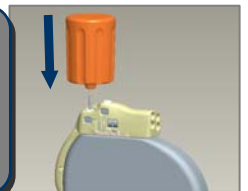

**Step 3.** Insert the lead and verify that the lead terminal pin is clearly visible beyond the connector block.

Lead terminal pin is clearly visible beyond connector block.

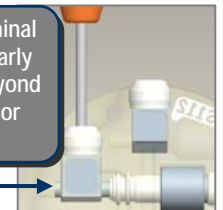
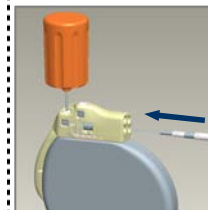

**Step 4.** Ensure the torque wrench is seated perpendicular (90°) to the connector block. While maintaining pressure on the lead, tighten the setscrew by *slowly* rotating the torque wrench clockwise until it ratchets once, keeping the torque wrench perpendicular to the connector block while tightening.

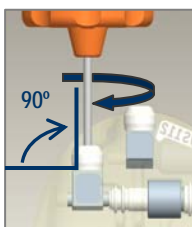

Wrench and setscrew are seated straight into connector block.

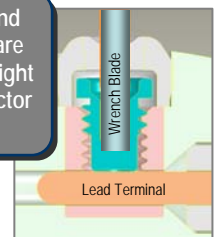

**NOTE:** It is unnecessary to apply additional downward force to the torque wrench while tightening the setscrew.

Remove wrench.

**Step 5.** Remove the torque wrench by pulling it straight out of the connector block.

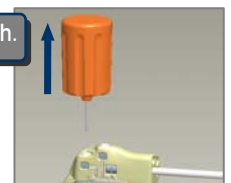

**Step 6.** Verify lead connection by applying gentle traction to *each individual lead terminal*. Do not pull on the yoke or more than one lead terminal at a time. If a lead terminal is not secure, reinsert the torque wrench, loosen the setscrew by rotating the wrench counterclockwise, and repeat Steps 3-6.

Apply gentle traction to each individual lead terminal.

